

# RECORD OF SURVEYS IN MORGAN COUNTY, INDIANA.

Corner INDEX Section 28 Township 11 North, Range 2E

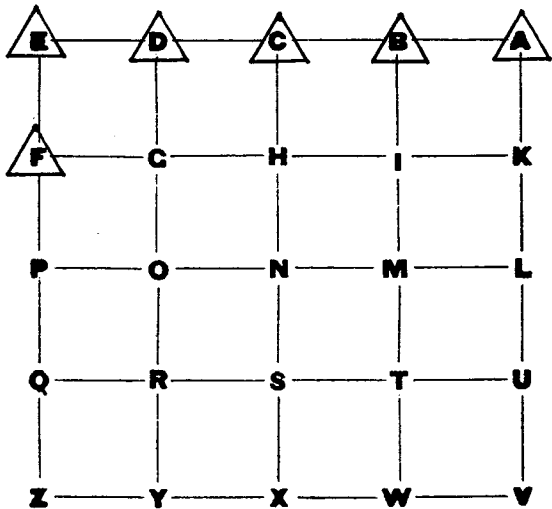

# RECORD OF SURVEYS IN MORGAN COUNTY, INDIANA.

Corner "A" Section 28 Township 11 North, Range 2 East

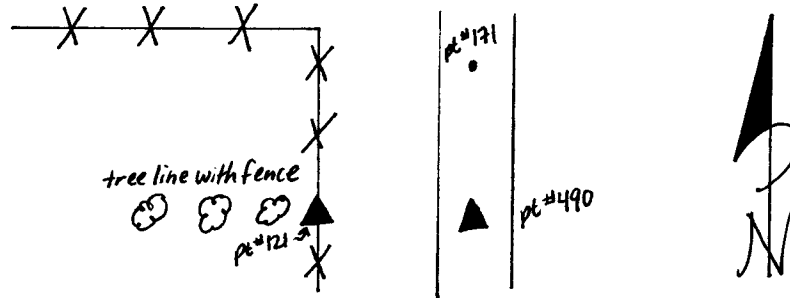
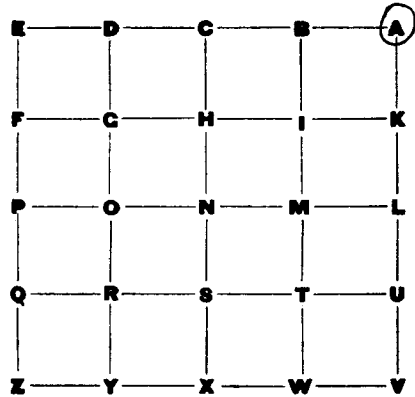

January 11, 1994

Field Crew: Richard Tapp & Michael Sheppard

(Point #490) Set 30" long copper weld rod in E of Whetstone Road, even with road surface.

Reference	Bearing	Distance
(pt #121) 1. iron pipe in concrete (found)	N 88° 44' 10" W	17.54'

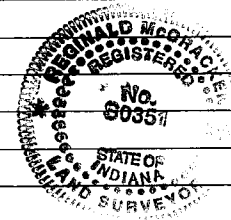

A cut limestone monument with engraved "W" was found in the mid 1970s in an existing fence/tree line, but subsequently was bulldozed out. A concrete monument was set (point #121) at the same location as the limestone monument found. At that time I believed the limestone monument (point #121) was the location of the "A" stone. However, now given survey data representing one mile in each of the four cardinal directions, I have set a new monument for this corner.

Reginald M. Cracker Morgan County Surveyor July 22, 1994

# RECORD OF SURVEYS IN MORGAN COUNTY, INDIANA.

Corner "B" Section 28 Township 11 North, Range 2 East

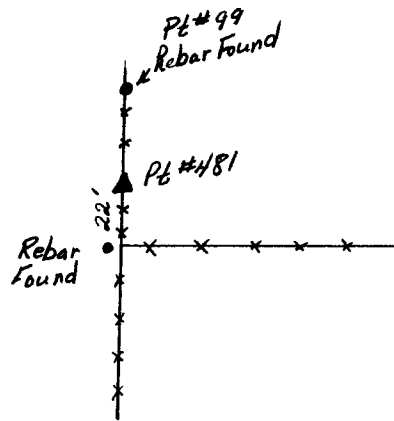
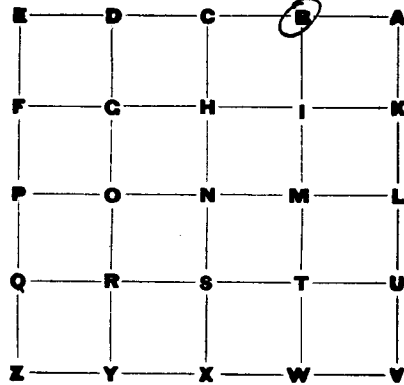

January 18, 1994  
Field Crew: Richard Tapp & Michael Sheppard

(pt. #491) Set 5"x5" limestone monument with brass cap.

Reference	Bearing	Distance
(pt. #490) 1. "A" 528 TUN R2E	S 89° 48' 52" E	1320.52'
(pt. #493) 2. "C" 528 TUN R2E	N 89° 49' 02" W	1320.58'
(pt. #99) 3. 5/8" Rebar found, set by ROH	N 00° 53' 49" W	22.68'

Registered M<sup>c</sup> Craske Morgan County Surveyor July 21, 1994



# RECORD OF SURVEYS IN MORGAN COUNTY, INDIANA.

Corner "C" Section 28 Township 11 North, Range 2 East

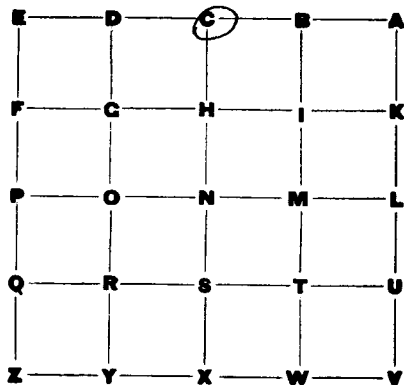

January 21, 1994

Field crew: Richard Tapp & Michael Sheppard

(pt #493) Set 3/4"  $\phi$  black iron pipe which is 4' long. There is 6" of pipe left above ground surface. The original survey stone had been bulldozed out.

	Reference	Bearing	Distance
(pt #481)	1. "B" S28T11N R2E (Set)	S88°49'07"E	1320.58'
(pt #492)	2. "C" S28T11N R2E (Set)	N88°37'46"W	1339.68'
pt #428	3. "S" S21-T11N-R2E stone fd.	N00°10'12"W	1364.95'

Reginald M. Crocker Morgan County Surveyor July 7, 1994

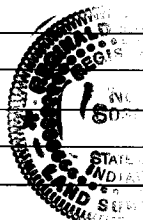

# RECORD OF SURVEYS IN MORGAN COUNTY, INDIANA.

Corner "D" Section 28 Township 11 North, Range 2 East

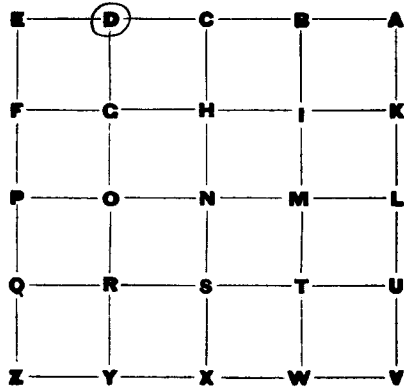

January 13, 1994

Field crew: Richard Tapp & Michael Sheppard

(point #492) Set 5"x5" limestone monument with brass cap. Stone is 6" above ground surface.

Reference	Dia.	Bearing	Distance
(pt #183) 1. Hickory	1"	N 87° E	13.3'
(pt #184) 2. Poplar	28"	N 79° E	22.8'
(pt #164) 3. "E" S28T11N R2E		N 88° 37' 57" W	1339.69'
(pt #493) 4. "D" S28T11N R2E		S 88° 37' 46" E	1339.68'
pt #178 5. headpost		N 76° E	13.65'

Reginald McCracken Morgan County Surveyor July 7, 1994

RECORD OF SURVEYS IN MORGAN COUNTY, INDIANA.

Corner "E" Section 28 Township 11 North, Range 2 East

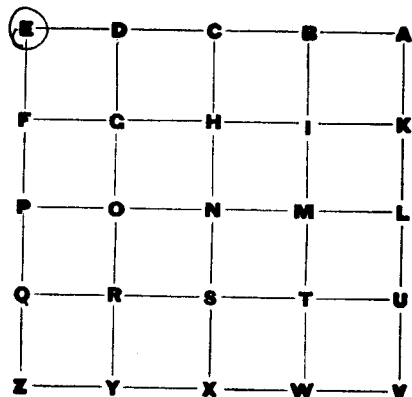

*SEDWICK  
DITCH*

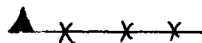

HOG  
PEN



July 8, 1994

Field crew: Richard Tapp, Michael Sheppard & Sarah Gray

(point #164) Found a 3/4" black iron pipe that is 4.7' long for the "E". Pipe is located on the East side of creek. (Sedwick Ditch)

Registered M. Cracker Morgan County Surveyor July 22, 1994

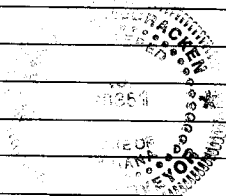

# RECORD OF SURVEYS IN MORGAN COUNTY, INDIANA.

Corner "F" Section 29 Township 11 North, Range 2 East

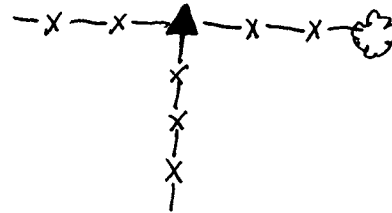
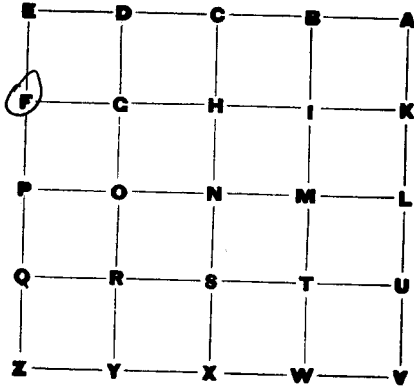

May 18, 1993  
Field Crew: Richard Tapp & Reginald McCracken

(point # 63) Found 6" long (N/S) sandstone which comes to a ridge (N/S). Old reference from 1935 are there, but are now stumps.

Reference	Dia.	Bearing	Distance
1. Maple	12"	East	11'

Reginald M<sup>c</sup>Cracken Morgan County Surveyor June 14, 1993

Also, pt # 253 Higgins. 500 6/22/94

