

RECORD OF SURVEYS IN MORGAN COUNTY, INDIANA.

Corner INDEX Section 24 Township 11 North, Range 1E

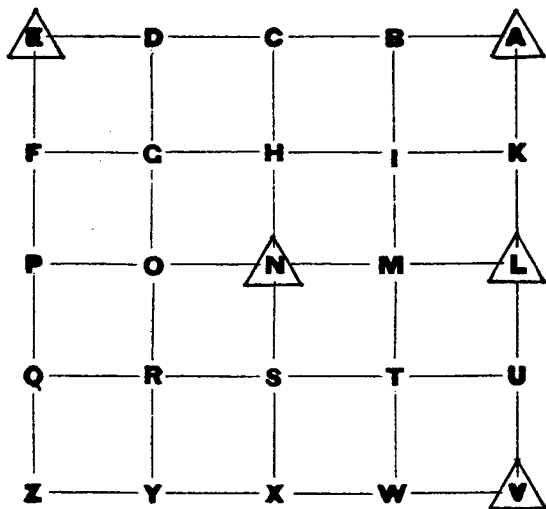

RECORD OF SURVEYS IN MORGAN COUNTY, INDIANA.

Corner "A" Section 24 Township 11 North, Range 1 East

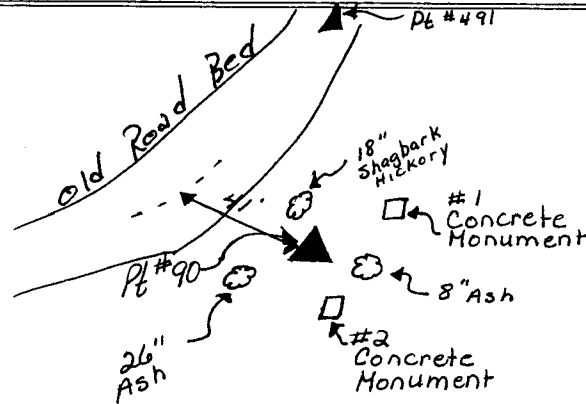
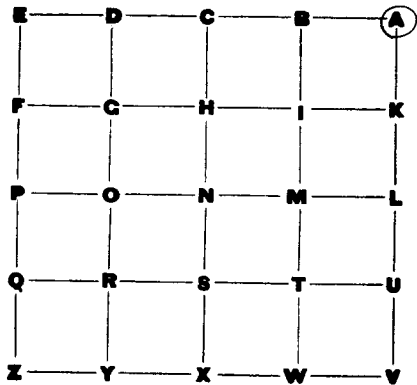

June 23, 1994

Field crew: Richard Tapp & Michael Sheppard

(Point #90) Found 4"x4" concrete monument with engraved 'x'. Monument is 9" above ground surface.

(Reference per Reginald McCracken in Old reference book.)

Reference	Dia.	Bearing	Distance
1. Concrete Monument		N 51° 49' 25" E	13.54'
2. Concrete Monument		S 15° 43' 20" W	11.07'
(Pt #491) 3. "Z" S 18° 11' N R 2 E		N 00° 43' 52" W	117.49'
4. Shagbark Hickory	18"	N 15° W	10'
5. Ash	26"	S 50° W	
6. Ash	8"	S 25° E	

Reginald M^o Crackee Morgan County Surveyor June 25, 1994

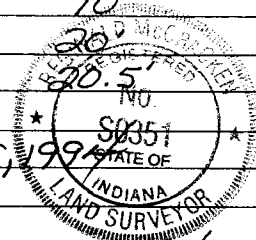

RECORD OF SURVEYS IN MORGAN COUNTY, INDIANA.

Corner "E" Section 24 Township 11 North, Range 1 East

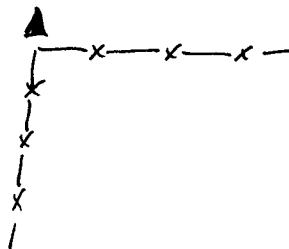
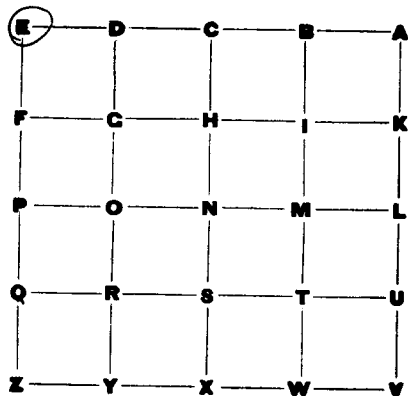

March 10, 1994
Field crew: Richard Tapp & Michael Sheppard

(point # 73) Found 8"x4" sandstone, a chisled 'x' was put on stone.
Stone is approximately 15" below ground surface, near next
to a fallen fence corner post. The concrete reference monuments
were set by Charles Johnson in the 1970's.

Reference	Bearing	Distance
1. Concrete Reference monument	S 46° W	26.15'
2. Concrete Reference monument	S 8° E	14.28'
3. Concrete Reference monument	N 76° E	14.92'

Reginald McCracken Morgan County Surveyor June 23, 1994

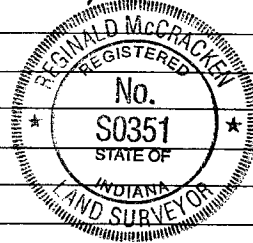

RECORD OF SURVEYS IN MORGAN COUNTY, INDIANA.

Corner 2 Section 24 Township 11 North, Range 1 East

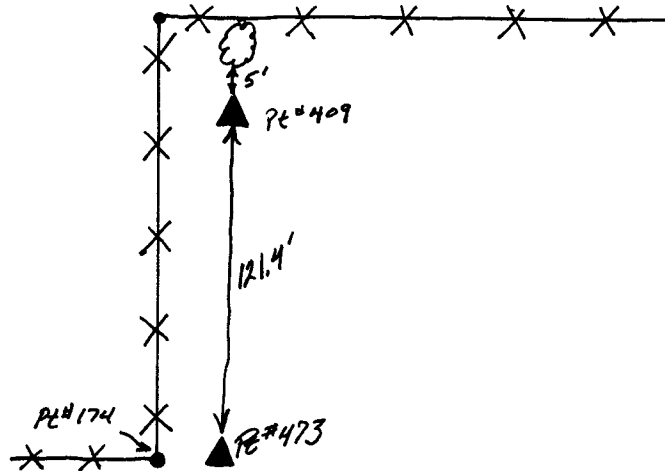
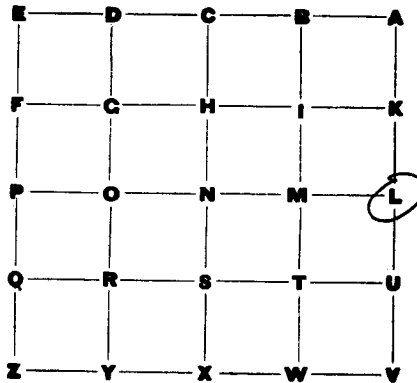

June 20, 1994

Field Crew: Richard Tapp, Michael Sheppard & Sarah Gray

(Point #473) Set 1 1/2" rebar 6" above ground and approx. 4 to 5' east of broken down N.S. fence. An orange marker was placed beside rebar.

Reference	Dist.	Bearing	Dist.
(PE#409) 1. Reference "P" 519 T11N R2E		N 00° 59' 35" W	121.4'
(PE#472) 2. White Oak ("P" 519 T11N R2E (in roots) 16" ^{comp})	16"	N 00° 59' 32" W	126.4'
(PE#174) 3. Head post		N 65° W	9.6'

Reginald M. Craker Morgan County Surveyor June 23, 1994

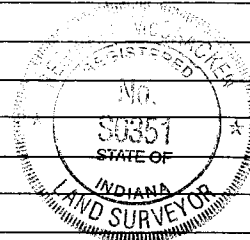

RECORD OF SURVEYS IN MORGAN COUNTY, INDIANA.

Corner "N" Section 24 Township 11 North, Range 1 EAST

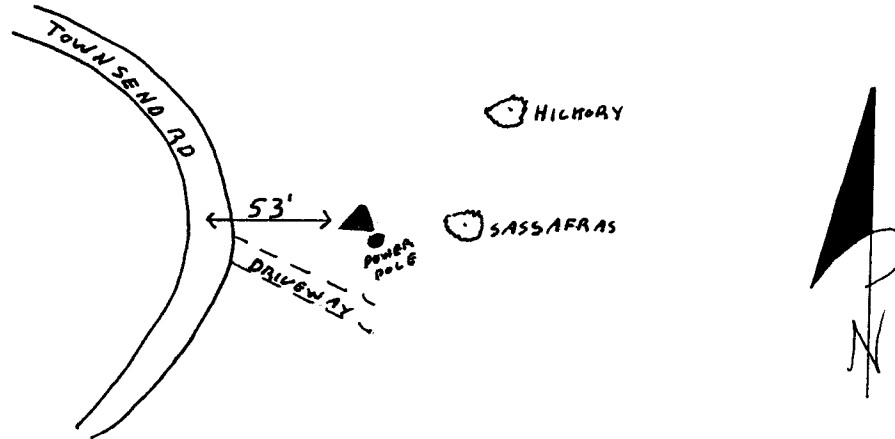
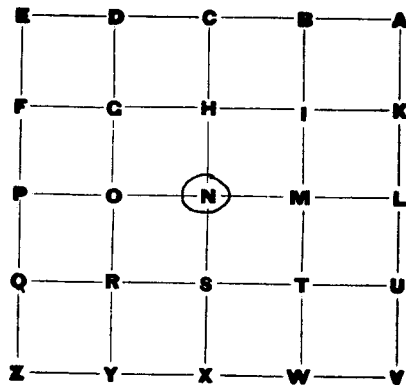

JUNE 24, 1994

FIELD CREW: MIKE SHEPPARD, RICK TAPP & SARAH GRAY

(POINT #251) FOUND 8" X 7" ENGRAVED SANDSTONE 1" BELOW GROUND WITH A 1" Ø I. PIPE ON WEST SIDE 1' ABOVE GROUND. STONE IS 53' EAST OF TOWNSEND ROAD'S CENTER.

REFERENCE	BEARING	DIST
1. 20" Ø PIENUT HICKORY	N 53° E	25.3'
2. 14" Ø SASSAFRAS	N 88° E	14.0'
3. POWER POLE	S 15° E	2.1'
4. 1" Ø BENT I. PIPE	N 75° W	16.0'
5. ½" Ø REBAR	S 83° E	7.93'
6. " " "	S 20° E	7.53'
7. " " "	N 72° W	8.12'
8. " " "	N 40° E	7.9'

Reginald M. Cracker Morgan County Surveyor June 25, 1994

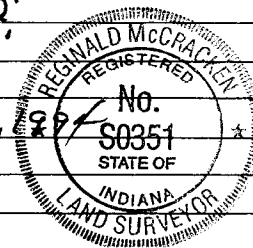

RECORD OF SURVEYS IN MORGAN COUNTY, INDIANA.

Corner "V" Section 24 Township 11 North, Range 1 East

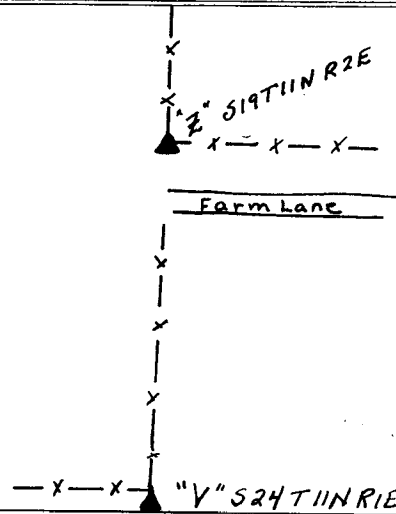
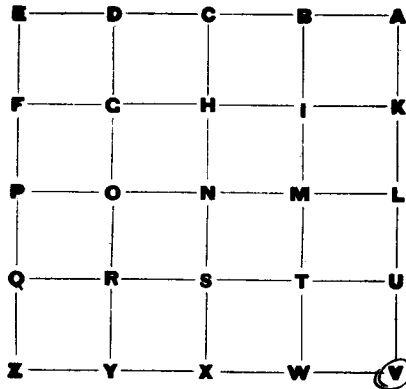

May 13, 1992

Field crew: Gregory Randolph & Richard Tapp

(point #9) Found 3" x 3" cut sandstone, 4" below ground surface.

Reference	Bearing	Distance
(point #1) "Z" 519 T 11 N R 2 E	N 03° 23' 22" E	135.03'

Reginald McCracken Morgan County Surveyor May 13, 1992

Also pt # 53, Mud. 200 NE. 5/18/93

