

RECORD OF SURVEYS IN MORGAN COUNTY, INDIANA.

Corner INDEX Section 19 Township 11 North, Range 2E

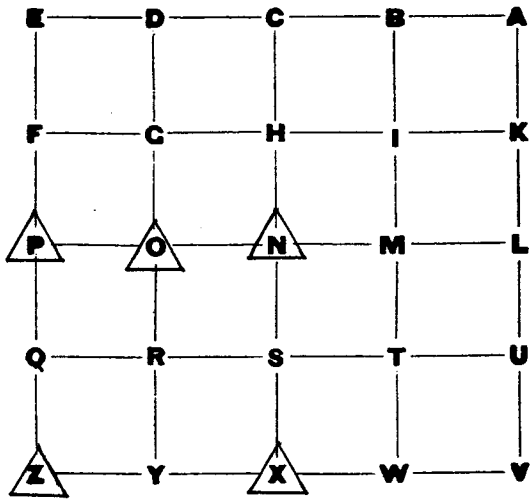

RECORD OF SURVEYS IN MORGAN COUNTY, INDIANA.

Corner "N" Section 19 Township 11 North, Range 2 East

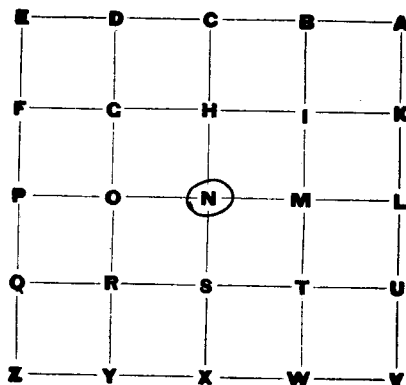

May 13, 1992

Field crew: Richard Tapp & Gregory Randolph

(point # 10) Found 4"x5" cone shaped grey granite with rebar bent over top of stone. In the middle of woods and \approx 100' North of power line.

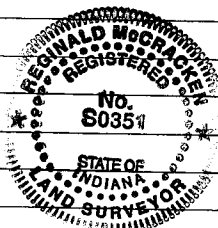

	Reference	Bearing	Distance
(point # 8)	1. "X" S19 T11 N R2 E	S01°23'25" W	2670.4'

Reginald McCrecker Morgan County Surveyor May 13, 1992

Also point # 43 Mud. 200 NE 5-18-93

Also point # 233 Higgins. 500 Disk #4 REM 6-23-94

RECORD OF SURVEYS IN MORGAN COUNTY, INDIANA.

Corner "0" Section 19 Township 11 North, Range 2 East

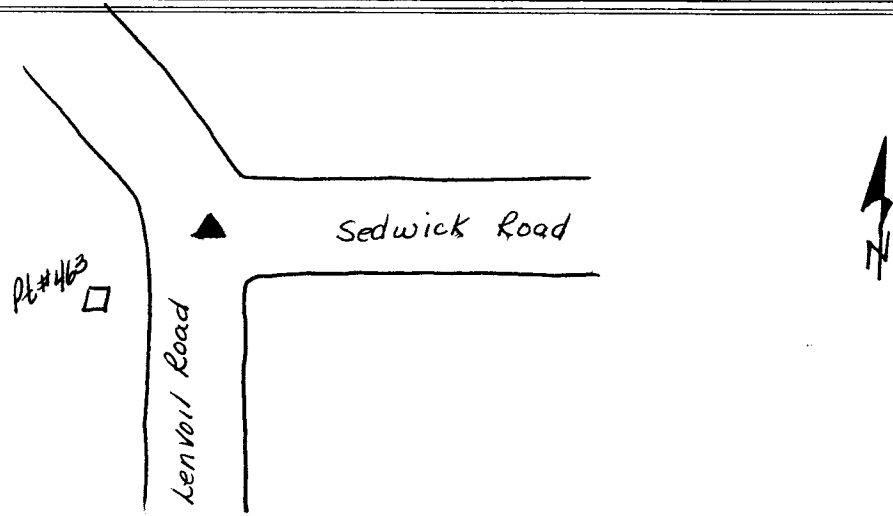
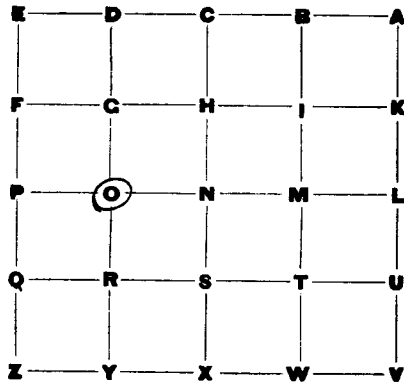

September 5, 1995

Field crew: Michael Sheppard, Richard Tapp & Reginald McCracken

(Point #464) Set copper weld rod with chiseled 'X' in top, flush with asphalt road surface. Located in the East edge of North Road and 1/2 of both East and South roads.

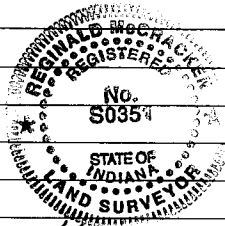

Reference
(pt #463) USGS Benchmark

Bearing
S 30° 46' 07" W

Distance
38.3'

Reginald McCracken Morgan County Surveyor Sept 5, 1995

RECORD OF SURVEYS IN MORGAN COUNTY, INDIANA.

Corner "P" Section 19 Township 11 North, Range 2 East

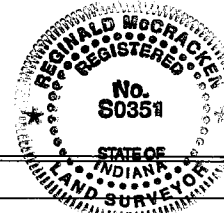
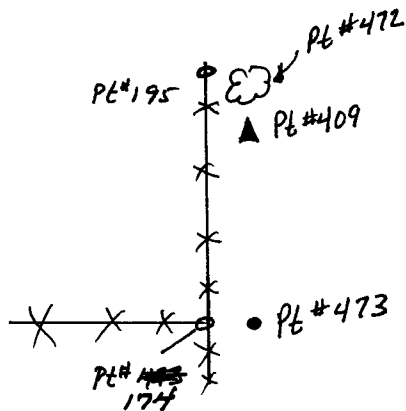
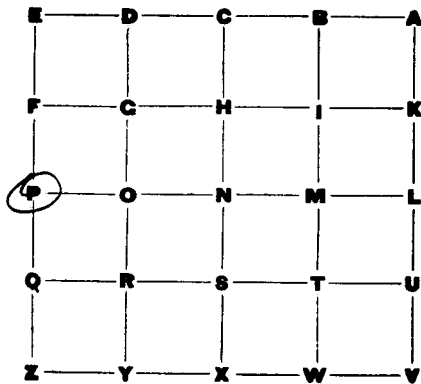

June 22, 1994

Field Crew: Richard Tapp, Michael Sheppard & Sarah Gray

(Point #409) Set a 5" x 5" limestone monument with brass cap for a reference for the "P" stone. Monument is 6" above ground with orange marker beside it. The reference monument is set on line from "L" 524 T11N R1E to "P" 519 T11N R2E and is 5" south of actual corner for the "P". The "P" 519 T11N R2E was not set due to falling in a 16" Ø white Oak.

Reference	Dist	Bearing	Dist.
(Pt #472) 1. "P" 519 T11N R2E Computed (White Oak) 16"		N 01° W	5'
(Pt #473) 2. "L" 524 T11N R1E (Set)		S 00° E	121.4'
(Pt #174) 3. Headpost		N S 03° 14' 24" W	117.54'
(Pt #195) 4. Headpost		N 69° 04' 48" W	6.31'

Reginald McCracken Morgan County Surveyor June 25, 1994

RECORD OF SURVEYS IN MORGAN COUNTY, INDIANA.

Corner "X" Section 19 Township 11 North, Range 2 East

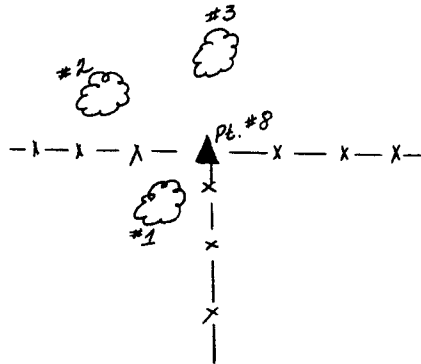
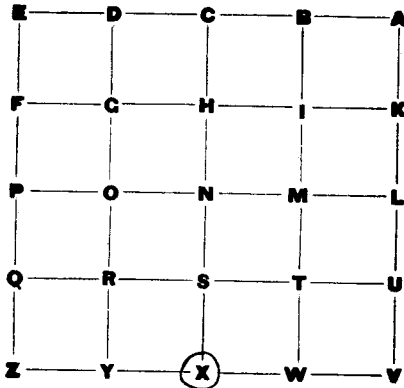

August 1, 1989

Field crew: Gregory Randolph, Rick Tapp & Patrick Lashbrook

(point #8) Found "X" stone. Stone is a 6" x 10" sandstone, 6" above ground and (\pm) 2' deep. Located on East side of corner post.

Reference	Dia.	Bearing	Dist.	(ALL COMPASS)
1. Beech	8"	S 37W	6'	
2. Beech	18"	N 68W	16.3'	
3. Beech	14"	N 9W	33.4'	
4. "Z" stone found	S19 T11N R2E (point #4)			
	N 88° 32' 56" W	2143.85'		

Reginald McGracken Morgan County Surveyor August 1, 1989

5-18-93

Also point # 42 Mud. 200 NE
 Also point # 344 Higgins Disk 4 SE 6.19.94

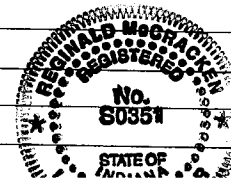

RECORD OF SURVEYS IN MORGAN COUNTY, INDIANA.

Corner "Z" Section 19 Township 11 North, Range 2 East

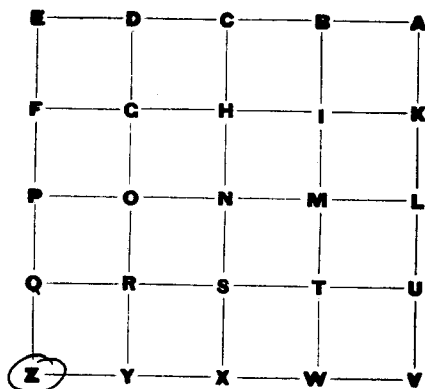

Note: This stone has been determined to be in error. The correct stone is 4.1 feet west. Refer to "E" 530-T11N-R2E dated June 24, 1994.
 Reginald M. Cracker 7-7-94

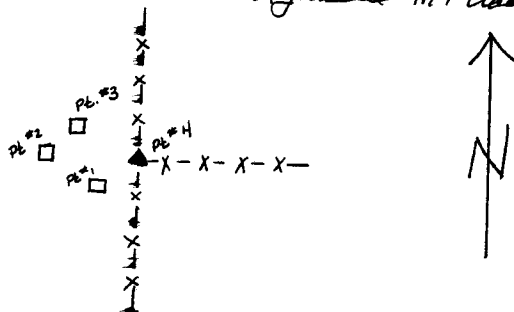

August 1, 1989

Field crew: Gregory Randolph, Rick Tapp & Patrick Lashbrook

(point #4) Found "Z" stone. Stone is a 3"x5" gray granite with engraved 'x'. Located in roots of Shagbark Hickory on SW side, 2" above ground and 1.5' deep.

Reference (all compass bearings)

1. Type 'A' concrete reference monument (point # 1)
 $S 7^{\circ} 01' 20'' W$ 21.22'
2. Type 'A' concrete reference monument (point # 2)
 $N 85^{\circ} 48' 55'' W$ 6.8'
3. Type 'A' concrete reference monument (point # 3)
 $N 8^{\circ} 03' 34'' W$ 9.44'
4. "X" stone found S19 T11N R2E (point # 8)
 $S 88^{\circ} 32' 56'' E$ 2145.85'

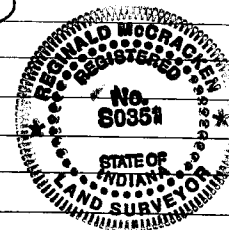

Reginald M. Cracker Morgan County Surveyor August 1, 1989