

Plat of  
Branch M Sherleys First Addition to the city of  
Martinsville Indiana.

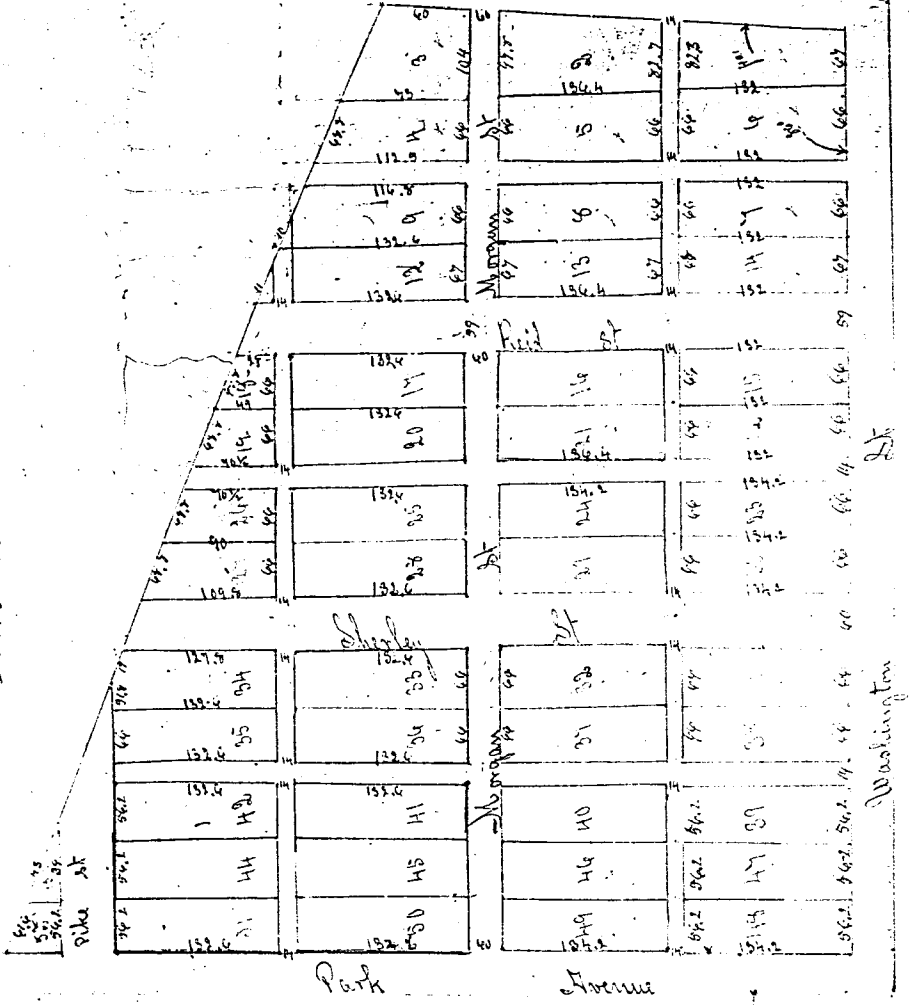

Description.

This addition is situated in the south west corner of section 35 Township 12 North Range one east in Morgan County Indiana. The south west corner of said section 35 is forty eight (48) feet wide. The south west corner of said section 35. All lots streets and alleys are of the size widths and dimensions shown on the plat. The lots in this addition are numbered consecutively from 1 to 52, both inclusive as shown on plat.

Lots numbered 11, 12 and 13 are the property of John and Fildem Reid. Lot numbered 16 is the property of Louey and Frank Striner. Lots 18 and 22 are the property Georgia Striner. All the remainder of the lots in this addition to wit: lots numbered from 1 to 10 both inclusive and lots numbered from 14 to 21 both inclusive and lot numbered 14 and lots numbered from 23 to 52 both inclusive are the property of Branch M Sherley.

D. W. Goss surveyor do hereby certify that the foregoing plat of Branch M Sherleys First Addition to the city of Martinsville Morgan County Indiana is made from actual survey and measurements.

1896 Goss.

Surveyor

We Sarah M. Sherley and William S. Sherley her husband, and Lucy Kriner and Frank Kriner her husband and Georgia Kriner Edward Kriner her husband and John Reid and Adam Reid hereby acknowledge the execution of the above and foregoing plat of Sarah M. Sherley's First Addition to the city of Mortonsville Morgan County Indiana, for the uses and purposes intended.

In Witness Whereof the said Sarah M. Sherley and William S. Sherley and Lucy Kriner and Frank Kriner and Georgia Kriner and Edward Kriner and Adam Reid and John Reid, have hereunto set our hands and seals this 7<sup>th</sup> day of October 1908.

Adam Reid (seal) Georgia Kriner (seal) Sarah M. Sherley (seal)  
 John Reid (seal) Ed Kriner (seal) W. S. Sherley (seal)  
 Frank Kriner (seal) Lucy Kriner (seal)

State of Indiana Morgan County ss:

Before me J. M. Baldwin a Justice of the Peace in and for said county and State this 7 day of October 1908. Personally appeared Sarah M. Sherley W. S. Sherley Georgia Kriner Ed Kriner Frank Kriner Lucy Kriner Adam Reid John Reid and acknowledged the execution of the above and foregoing Plat.

Witness my hand and seal this 7<sup>th</sup> day of October 1908.  
 J. M. Baldwin J. P. (seal)

Recorded October 13 1908. At 1 P.M.

W. R. McCracken R.M.C.

Report of Special Committee

To the Honorable Mayor and the common council of the of Mortonsville Indiana.

Gentlemen, your Special committee appointed to examine and report upon the plat of Sarah M. Sherley's First Addition to the city of Mortonsville would most respectfully report that they have examined said plat and the territory sought to be located thereby and recommend that said plat be accepted and approved, by the council

J. B. Riggan,  
 Geo. B. Schmidt, Committee.  
 Smith Johnson.

I certify that the foregoing report was received and concurred in by the common council of the city of Mortonsville Indiana, at its regular meeting, Monday evening Oct 7. 08.

J. C. Guselman,  
 Clerk.

Recorded October 13 1908 At 1 P.M.

W. R. McCracken R.M.C.

188 Township  
 of Lot  
 corner of said  
 divisions

from 1 to 50.

numbered 16 is  
 Georgia Kriner  
 and from 1 to 10  
 numbered 14 and

Sherley  
 M. Sherley's  
 re from actual

FRANK A. THROOP MORTGAGE CO.

*Dealing Exclusively in  
National Housing Act Title II Insured Mortgages*

907 Electric Building - Riley 4204  
INDIANAPOLIS, IND.

July 3, 1936

Mr. Ed. V. Fletcher  
Rm. 3, Cunningham  
Martinsville, Indiana

In re: Chauncey Fletcher.

Dear Mr. Fletcher:

We obtained a survey in the Naylor case which was satisfactory. The Civil Engineers in Marion County provide a survey with copies for the sum of \$5.00. On this survey the Engineers show lot lines, building reconstruction, and location of all buildings on the lot with the distance from the edge of the building to the lot line. They also give Legal Description and make a certificate that their survey is accurate. The surveyor here actually goes out and sights for lot lines, as he would have to do when he gives the location of the building on the lot.

The Naylor survey when made by the County Surveyor was evidently copied from the Plat Book and therefore was not quite as satisfactory as the ones we get up here, but if there is no chance of the surveyor taking a personal trip to the property, we will have to take what we can get. The drawing attached to the Abstract is only a showing of the Plat and will not qualify as a survey.

I would suggest that you get a survey, and have it paid for by Chauncey Fletcher so that it will not disturb the present set-up of the distribution sheet.

Yours very truly,  
FRANK A. THROOP MORTGAGE CO.

GAB:LP

By

*Scott Rusten*

*Bungdon*



Chauncy Fletcher

CERTIFICATE OF SURVEY

Lot No.23, S. M. Shirley's First Addition to the City of Martinsville, Ind.

Described as follows: To-wit:

Beginning at a point on North line of Washington Street that is 35 feet North and 96 feet (North  $89\frac{1}{4}$  East) of the intersection of the center line of Washington Street and the center line of Shirley Street, in City of Martinsville, Indiana. Said point being the Southwest corner of Lot No.23 in S. M. Shirley's First Addition to the City of Martinsville, Ind. Thence North  $\frac{3}{4}$  degrees West along and over West line of said lot, a distance of 133.1 feet to Northwest corner of said lot: Thence North 89 degrees and 22 minutes East along and over North line of said lot, a distance of 66 feet to Northeast corner of said lot: Thence South  $\frac{3}{4}$  degrees East, along and over East line of said lot, a distance of 132 feet to Southeast corner of said lot: Thence South  $89\frac{1}{2}$  degrees West along and over South line of said lot, a distance of 66 feet to Southwest corner of said lot, the place of beginning.

I, Wilbur F. Smith, Professional Engineer, Registered No.2284, State of Indiana, do hereby certify that the above description was made by me from an actual survey upon and over said described tract of land.

Witness my hand and seal this 9th day of July 1936.

---