

Note: Iron markers placed at three corners as shown on south line of SE 1/4 Bl. #1 Beryle N. Poston's 1st Addn. Iron markers placed 5ft. south of three north corners as shown because of new sewer trench E. & W. through center of block.

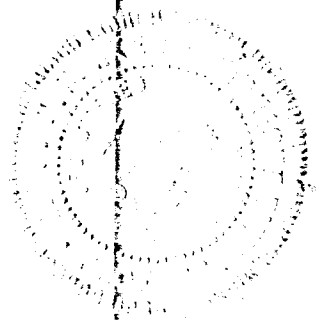
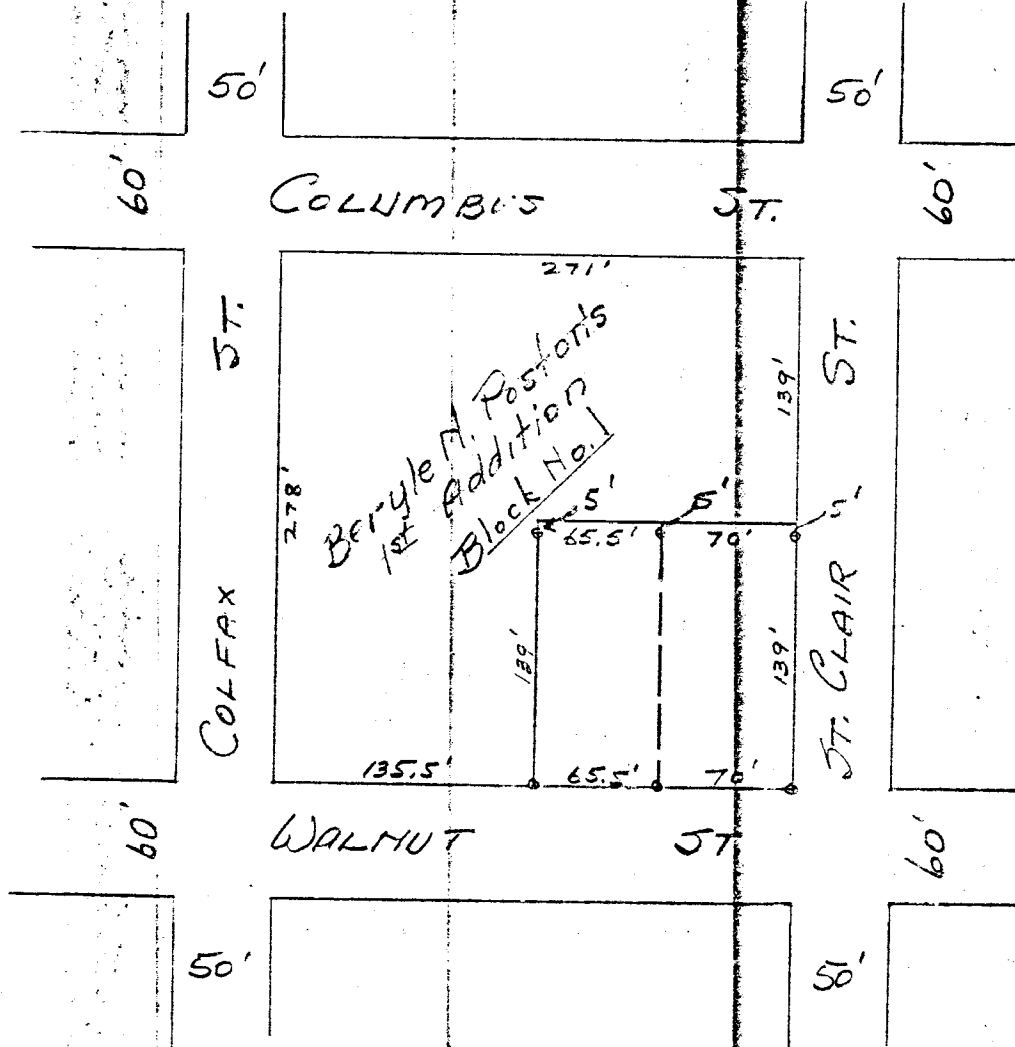

This survey for Charles J. Smith, owner, to divide quarter into two tracts according to existing fence.

PLAT OF SURVEY  
 SOUTHEAST QUARTER  
 BLOCK NO. 1  
 BERYLE N. POSTON'S 1ST ADDN.  
 CITY OF MARTINSVILLE  
 MORGAN CO., INDIANA.  
 SCALE 1" = 100' MARCH 6, 1950.