



Morgan County **COURTHOUSE RENOVATION**

Street Closure Plan

July 2025

New Judicial Campus – Opening This Summer!



- Grand opening: July 2, 2025
- New building:
 - App. \$46M of \$72M total project cost
 - 71,800 ft² over three floors
 - 21 restrooms
 - New parking lots
- All employees and offices in current Courthouse will be moved in by end of July

Existing Courthouse



- Previously housed six courts, plus support staff
- Complete interior renovation from summer 2025 to late 2026
- Exterior renovation includes reconfigured parking, new sidewalks, ADA-compliant ramps and curbs
- Once complete, it will house professionals working in the Administration Building and several other buildings around downtown

Approved Exterior Phasing Plan

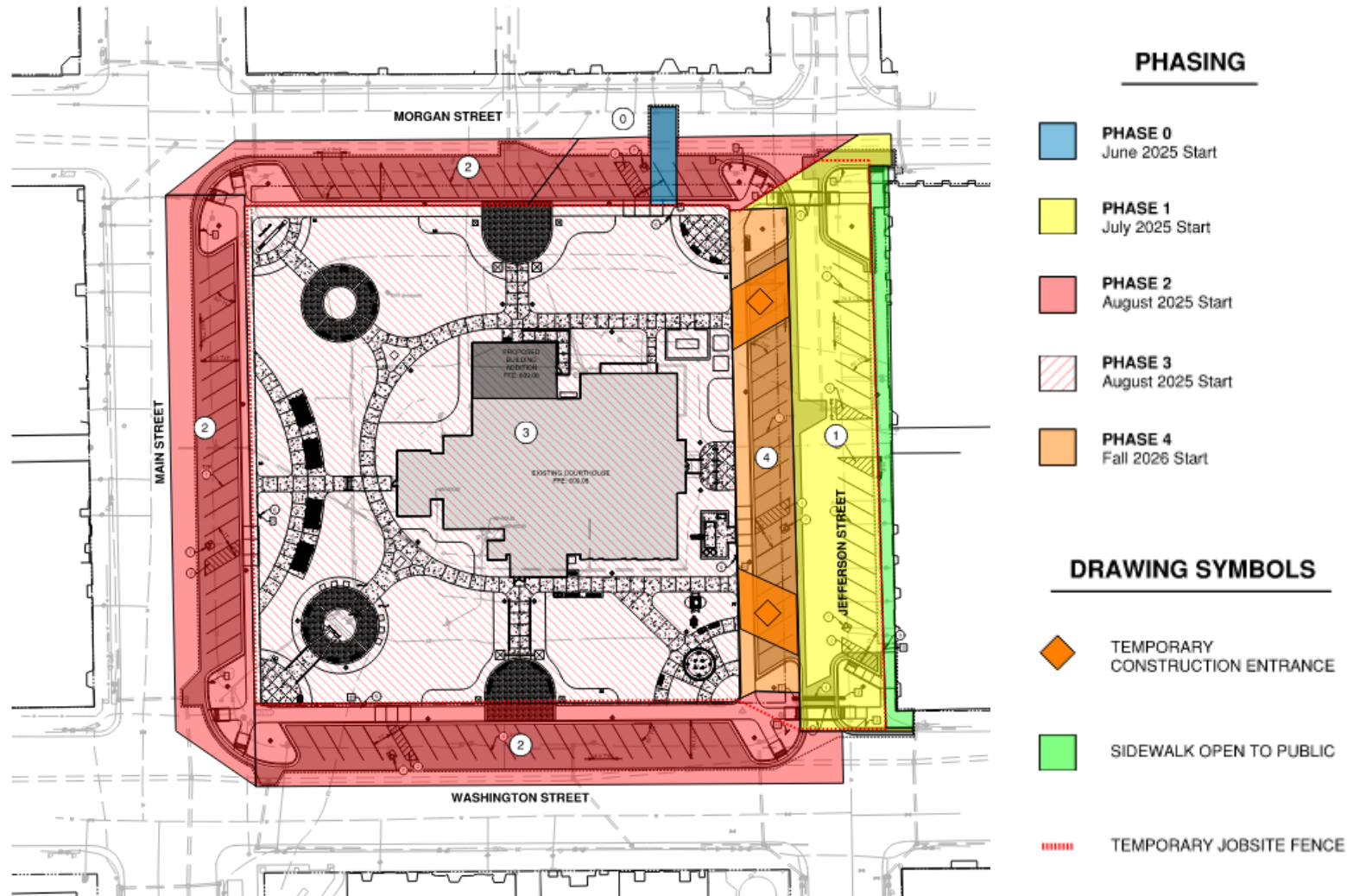

Jefferson Street:

- Mid-July – Begin utility and road work (4 weeks)
- August - Open southbound Jefferson and diagonal parking on the east side
- 23 parking spaces (3 new)
- West side new parking will be closed until Fall 2026
- Sidewalk will remain open during road work
- South end of sidewalk will close for two days to pour new curb and sidewalk extension (north end open)

Approved Exterior Phasing Plan

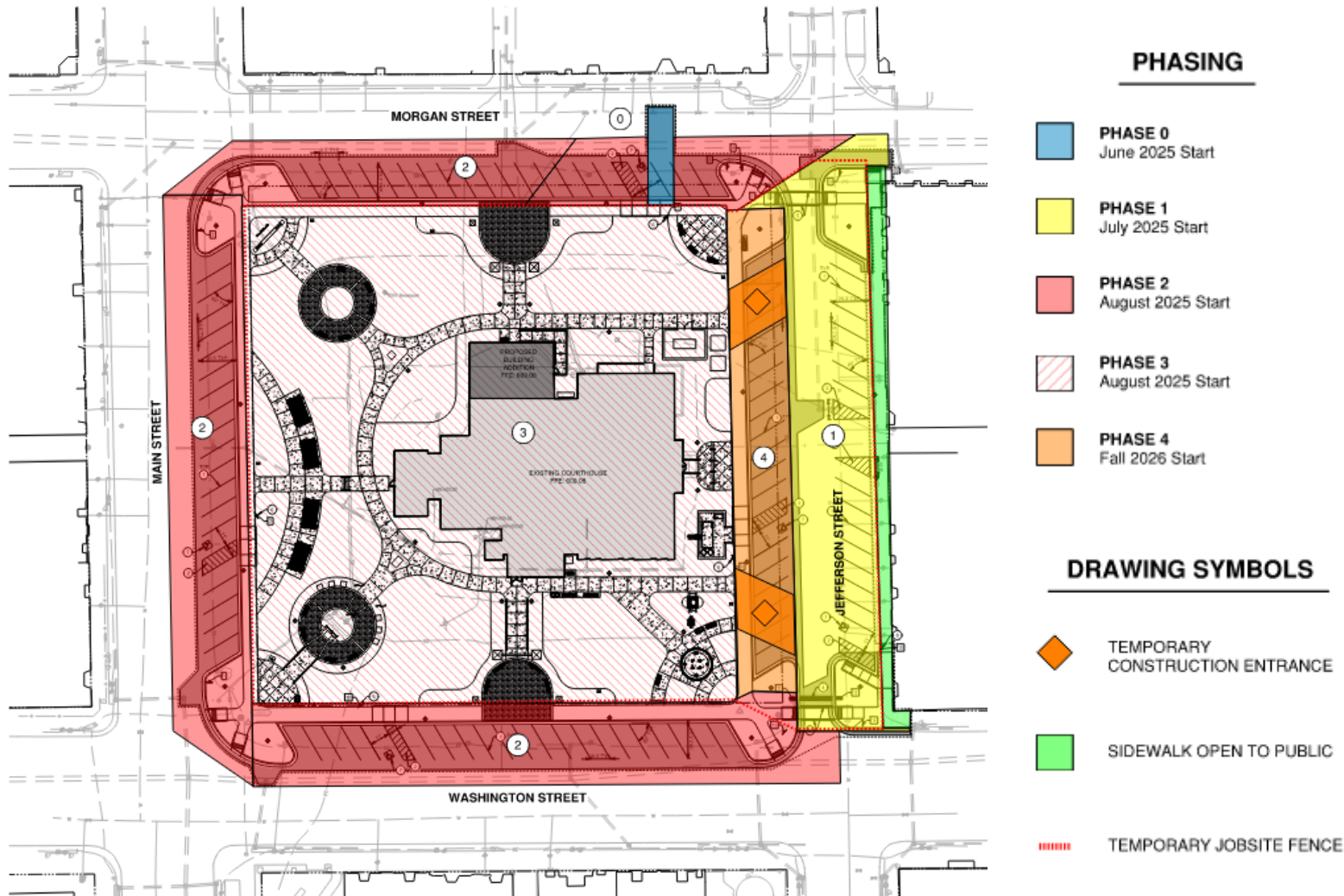

Morgan, Main and Washington Streets:

- Work begins after Jefferson reopens (16 weeks)
- One lane will be closed on each street, allowing one-way traffic
- Open by Thanksgiving 2025:
 - Parking spaces
 - Sidewalks
 - Signage
 - ADA ramps
 - 67 parking spaces (2 new)

Phasing Plan Impact Schedule

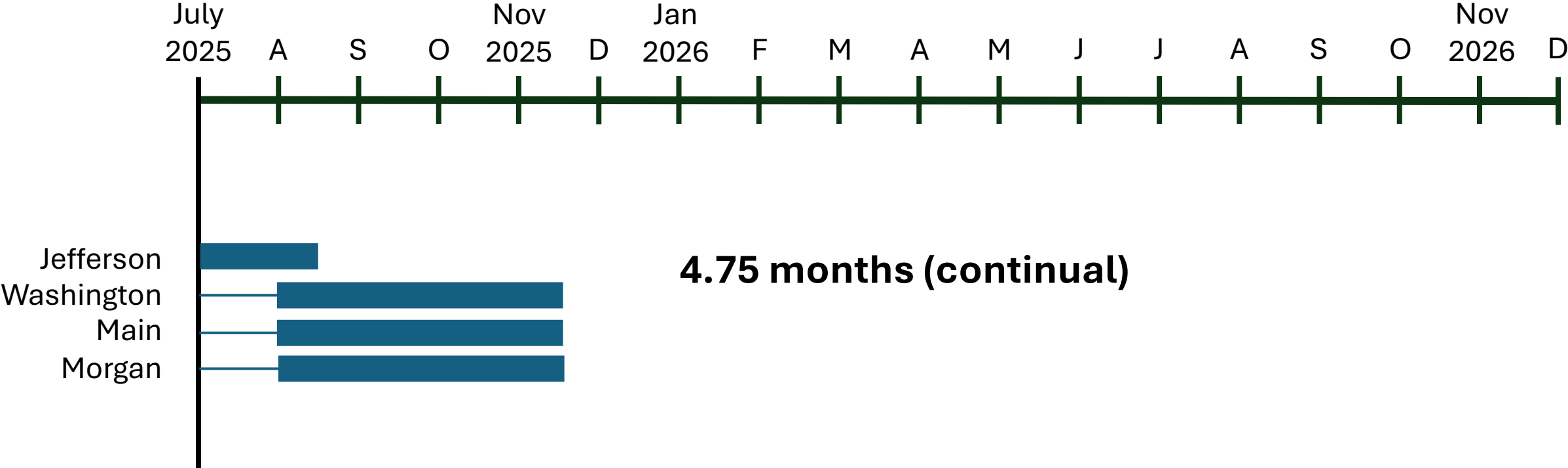

Approved Exterior Phasing Plan – Public Parking



LEGEND



OPEN DURING ALL PHASES
42 SPACES



OPEN DURING PHASE 1
26 SPACES

OPEN AFTER PHASE 2
63 SPACES



OPEN AFTER PHASE 1
23 SPACES

Downtown Parking Inventory (2026)

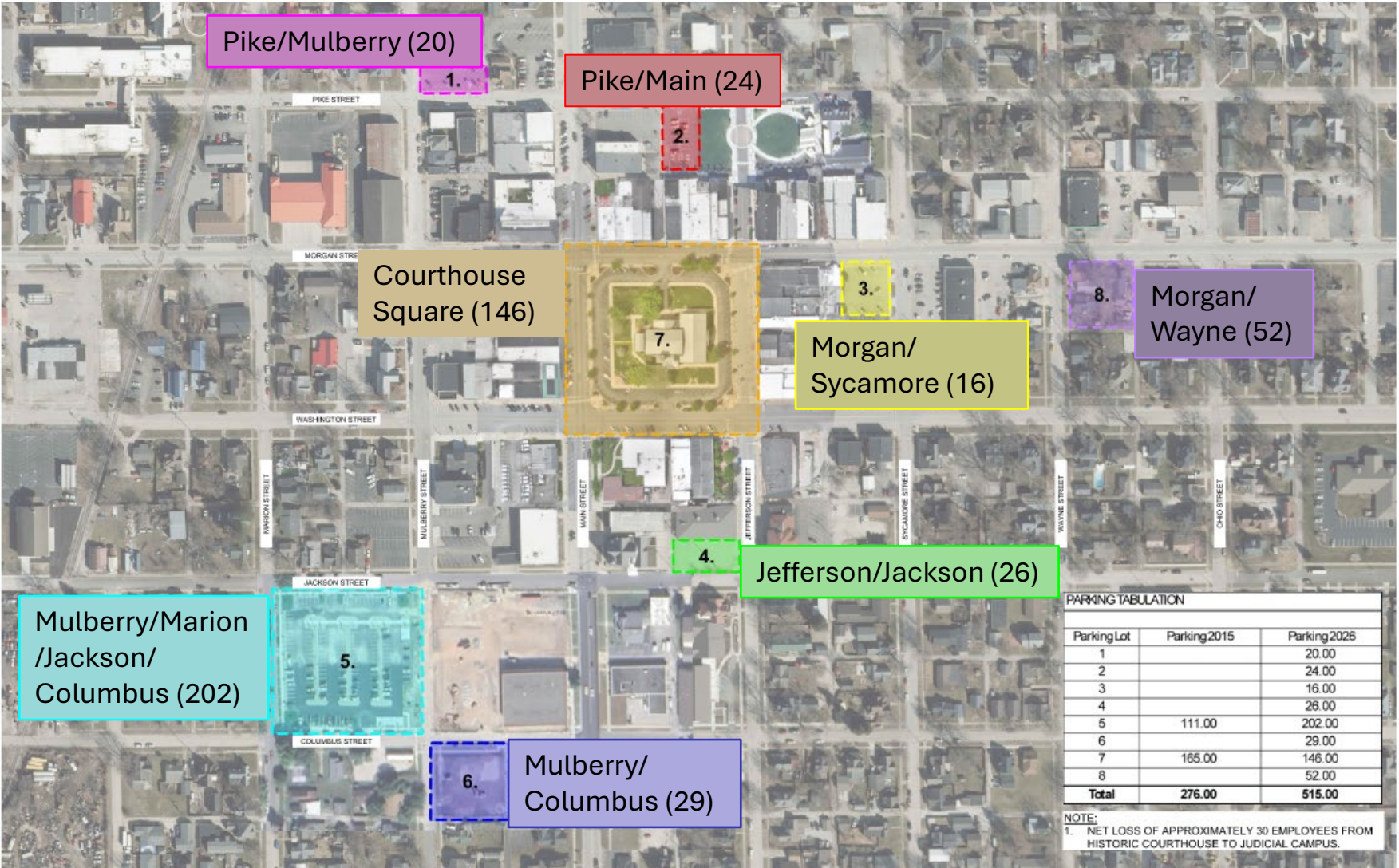

MORGAN COUNTY HISTORIC COURTHOUSE

Martinsville, IN

April 4, 2025

Parking Study

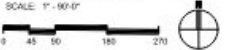

Thank you!

Please direct questions to
County Administrator Josh Messmer at
(765) 342-1007 or jmessmer@morgancounty.in.gov.